



Smart Floodlight Pro-Cam E8

Quick Installation Guide

1. Packing List

Open the package, then make sure the Smart Floodlight Pro-Cam (device) is intact, and with all the below accessories.



Smart Floodlight Pro-Cam



Installation Manual

Please refer to the installation pictures in the App, and read this manual and keep it handy during installation.



Hook

Hang your Smart Floodlight Pro-Cam while connecting the wires.

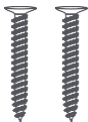

Screws(4). Use 2 of these to attach the supplied bracket to the wall.

图片数量要正确



Plastic Screw Sleeves (4)

Knock the plastic screw sleeve into the hole.



Electrical Caps (3)

Use these to connect Smart Floodlight Pro-Cam wires to your existing wires as shown in the diagram.



Waterproof rubber cap (2)

Use the waterproof rubber cap on the screw hole of the device.



WARNING

This manual is for information purpose only. Working with electricity can be dangerous unless proper safety precautions are taken. If you are not comfortable or are inexperienced with the processes and tools described in this manual, we recommend that you hire a licensed electrician.

2. How it all fits together

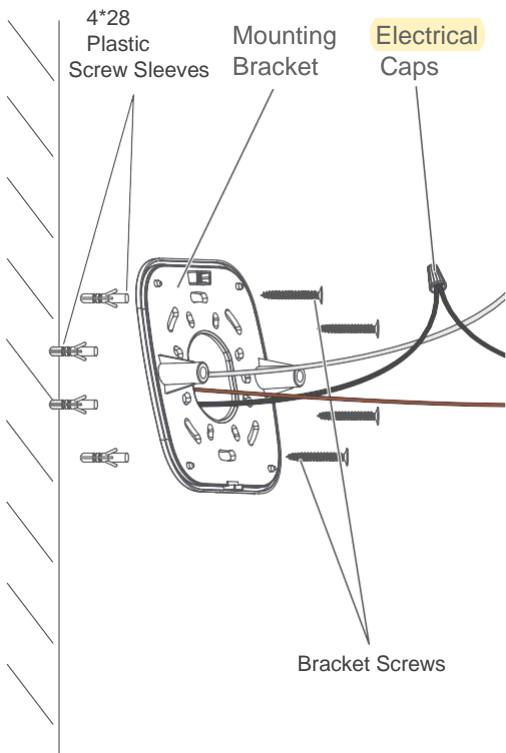

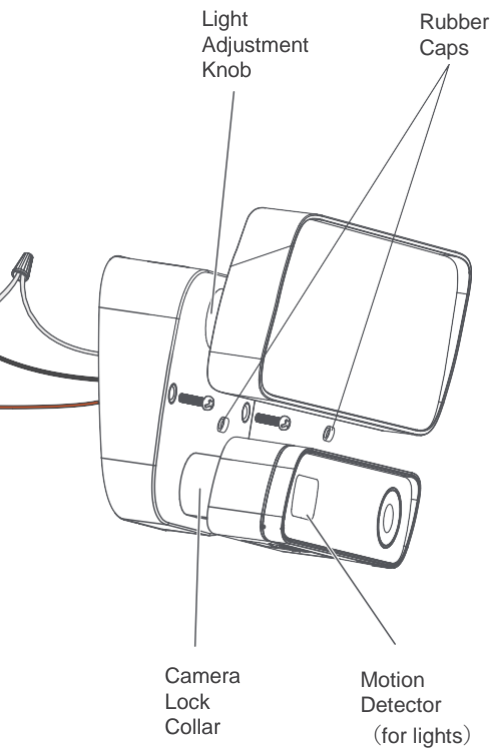

3. The proper installation height to optimize the motion sensor performance

i WARNING

In order to prolong service life of the equipment, please try to install the equipment in a place without rain and high temperature and humidity.

Parallel to ground

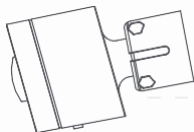

26 feet (8 Meters)

When mounted at 10 feet (3 meters) off the ground, with the motion detector tilted at about a 30 degree angle toward the ground. (Please refer to below diagram).
the Smart Floodlight Pro-Cam will detect human sized objects at a distance of up to 25 feet (8 meters).

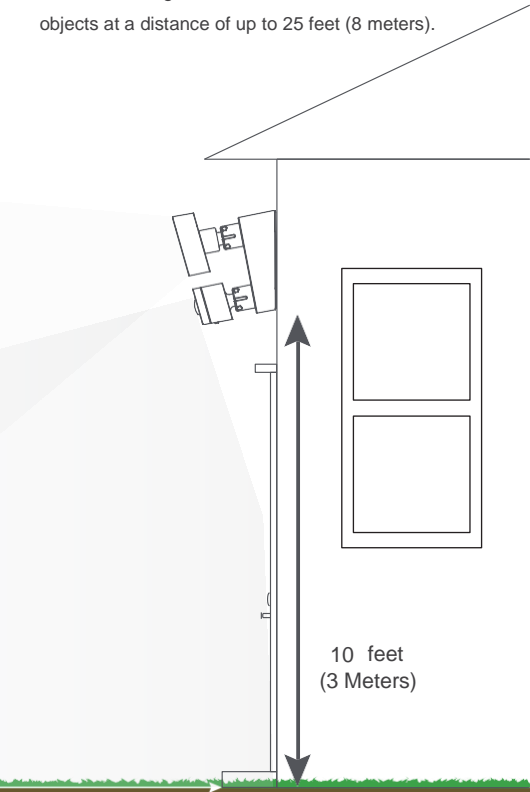

Step 1 - Shut power off at the breaker box.

If you don't know where your breaker box is or how to turn off power to the circuit where you are installing your Smart Floodlight Pro-Cam, Please consult with a licensed electrician.

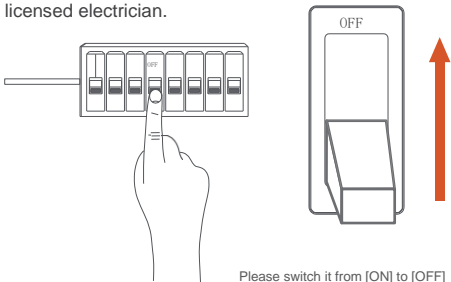

WARNING: Risk of electrical shock

- Disconnect power at the circuit breaker before installing.
- Verify that the supply voltage is correct.
- Connect fixture to a 110VAC – 240VAC 50/60 Hz power source.

- Properly ground fixture.
- Always follow code standards when installing wired connections.
- Installation and wiring must be performed by a licensed electrician.

CAUTION: Risk of fire

- Do not install near any combustible or flammable surfaces or liquids.

NOTICE

- Do not connect this light fixture to a dimmer switch or timer.

Step 2 - Remove the mounting bracket

- 1 Use a screwdriver to unscrew the screws.
- 2 Remove the mounting bracket.

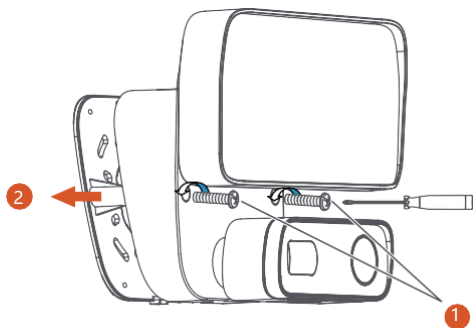

Step 3- Install the waterproof rubber gasket onto the bracket.

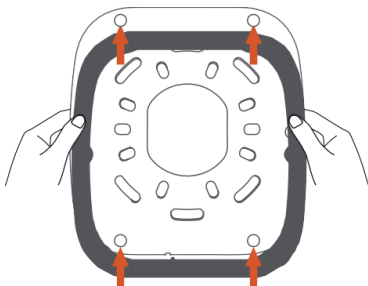

Attach the waterproof rubber gasket onto the mounting bracket, press into the 6 holes to fix it to the device.

Step 4- To determine the location

First, determine the height of the chassis, and then use a pen to draw the position of the screw holes and mark their position.

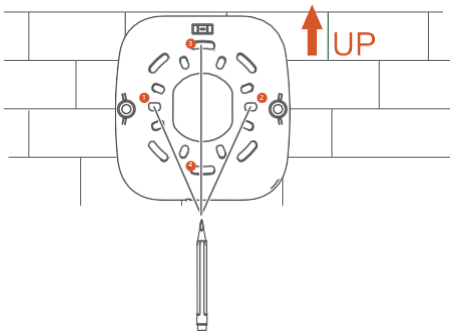

Step 5 - Choose a proper place for drilling

- 1 Before drilling, ensure that the holes do not Impact pipe work, cables, electrical wiring or other building services that may run through the wall.
- 2 Knock the plastic screw sleeve into the hole. Please use below diagram as reference.

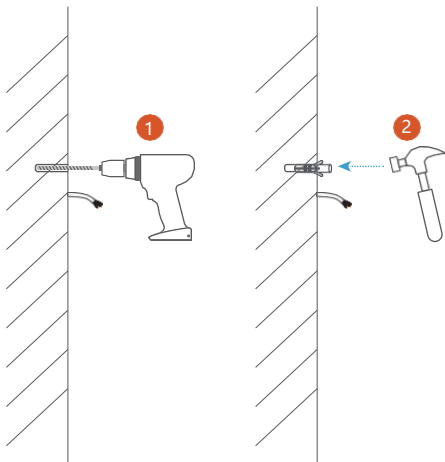

Step 6 - Fix base

Carefully push all the wires through the large opening in the bracket.

Tighten the screws and fix the base. Pay attention to the horizontal position on the top. Please reference below Diagrams.

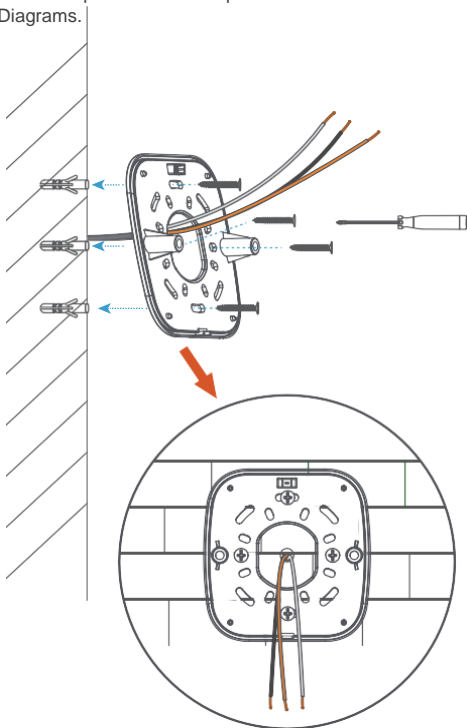

Step 7- Connect the power wire

Connect power wire to terminals Black(Hot) and White(Neutral)

颜色错误, 跟工厂确认电源极性, 千万不要犯错!

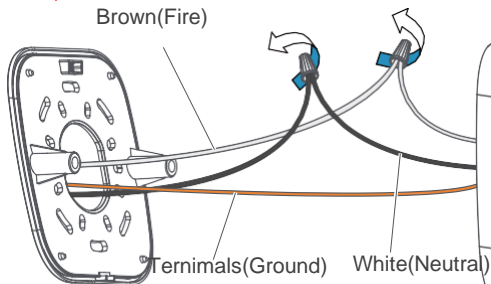

If you don't know which is neutral or fire wire coming out of the junction box, consult with a licensed electrician.

Align the mounting posts with the holes on Floodlight Cam and press together, securing the screw cap nuts with the screwdriver.

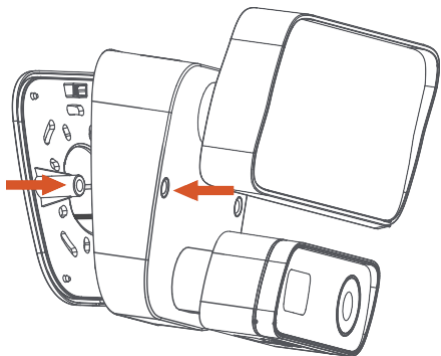

Step 8 - Mounting bracket

Tighten the screws with a phillips **什么意思?** head.

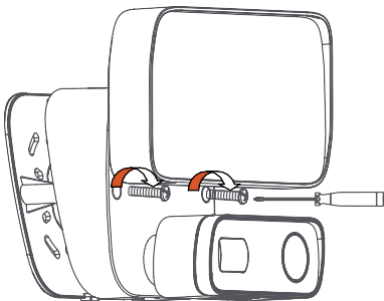

Put the waterproof rubber cap on the screw hole.

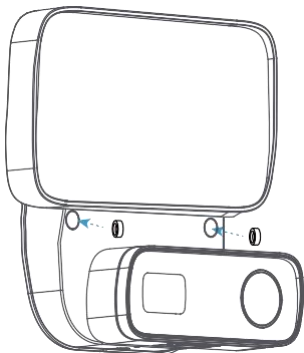

Step 9 - Adjust the Angle of the Floodlight and camera

Loosen or tighten the screw to adjust the Floodlight angle

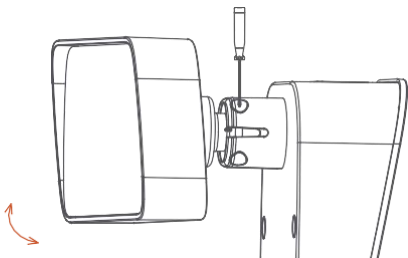

Loosen or tighten the screw to adjust the camera angle

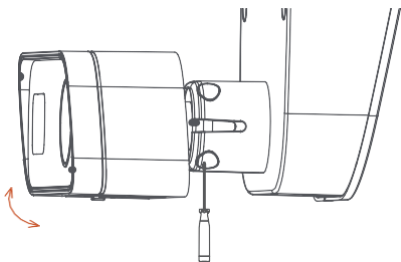

Do not remove your led light part or camera part from the ball socket on the base.

Step 10 - Restore power at the breaker box

After restoring power, the lights will turn on and your Smart Floodlight Pro-Cam will begin speaking to you to let you know it is in setup mode.



Please switch it from [OFF] to [ON]

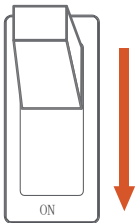

Step 11 - App setup

Open the App Xodo ProCam, follow the user manual to connect the Smart Floodlight Pro-Cam to your WiFi network.





换好点图片

Connect Smart Floodlight Pro-Cam
to Your APP

1.Preparation

Please prepare the below stuff before you use it.

One smartphone, or tablet (Mac or Windows PC is NOT acceptable) Smart Floodlight Pro-Cam is supported on IOS 10.0 or newer and Android OS 4.4 or Newer.



Android phone

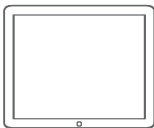

iPad



iPhone

Wi-Fi Router

- Device can only connect to 2.4Ghz Wi-Fi router.
- Make sure you turn on the DHCP of your router, and the MAC address should be off. 什么意思？

We suggest that the distance between your router and the device while being set-up should be within 15 feet (5 meters) during initial configuration.

- Please don't use special character such as symbols to name the WiFi.

- Please don't use special character such as symbols in your password, the WiFi and Wi-Fi password can not be left blank.



2.4G Wi-Fi

Wi-Fi Router

Green LED indicator status:

灯要绿色

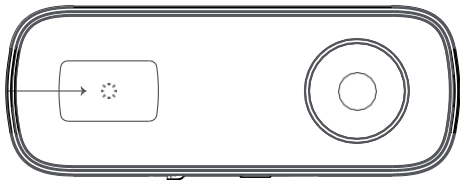

<ul style="list-style-type: none">● OFF No power or WiFi connected	<ul style="list-style-type: none">● ON Device is starting
<ul style="list-style-type: none">⚡ Fast blink WiFi disconnected	<ul style="list-style-type: none">⚡ Slow blink Waiting connect to WiFi

Micro SD card user caution

多大卡？

- To ensure SD card video recording works properly, we recommend a Class 10 or above version high speed Micro SD card.
- To make sure the device works normally, please properly format the SD card before first time use.
- Before inserting or removing the SD card, please power off the device. Insert the SD card properly into the slot as shown in the diagram below.

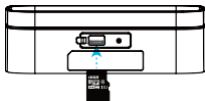

Correct

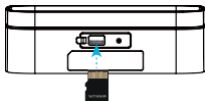

Wrong

2. Operation Instruction (IMPORTANT! please read.)

After installing the Smart Floodlight Pro-Cam, turn on the power and wait for about 40 seconds, you can move on to next step after the first chime or tone. you will hear the sound 3 times.



When configuring the device, please put your phone, WiFi router and the device as close as possible, otherwise, it could be failed.

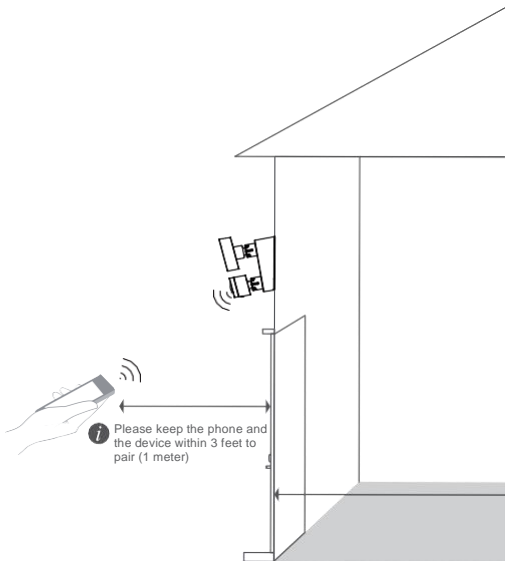

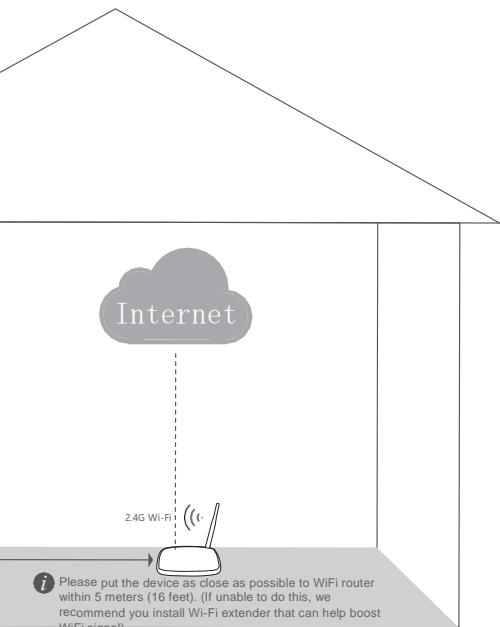

3. Configure Device

Open the App

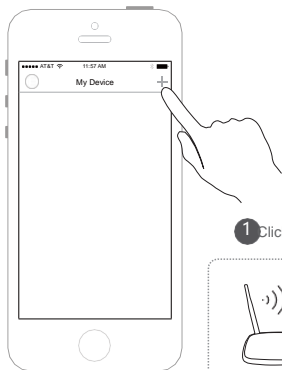

1 Click " + "

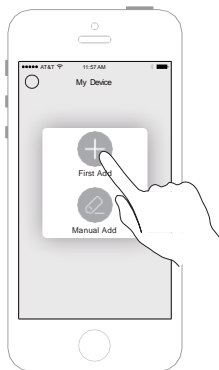
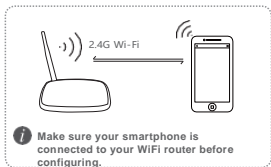

2 Click "First Add"

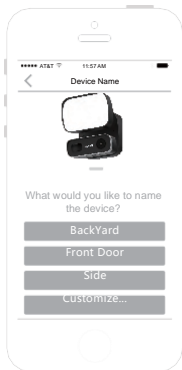

3 Name the device



4 Scanning the QR code on the back housing **标签要换掉，容易掉，最好放在说明书或包装盒上**

Option 1:

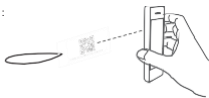

Option 2:

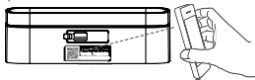



i WARNING

- Don't use Characters or special symbols in your WiFi name.
- Don't use Characters or special symbols in your WiFi password

• the WiFi
Input the correct password for

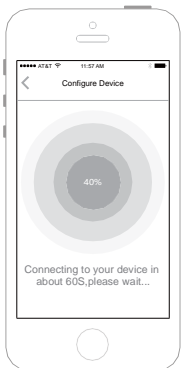

- 6** Please put your smartphone close to the device within 5m(16.5 ft), then press to configure.

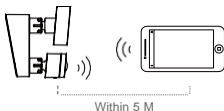

- i** Adjust the volume of your smartphone or tablet PC to maximum.

- 7** Wait for about 60 seconds, the configuration will be done.
(After the configuration is successful, the green LED indicator will be off in about 60 seconds.)

i If configuration failed

- Please make sure you input password correctly (check for capitals & small letter,blanks and case sensitive)
- Please keep the distance between the device and the WiFi router within 5m(16.5 feet).

Press and hold [RESET] Button for 5 seconds, the device is restored to factory default setting, repeat the configuration again. please see below diagram for reference.

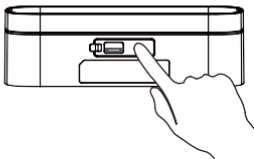

- 8** Click the screen to watch the video.



If the live video is frozen, please close it and open again. If it is still frozen, please power off and restart the device and the WiFi router, keep the device and the WiFi router within 5m(about 16.5ft) to configure again.

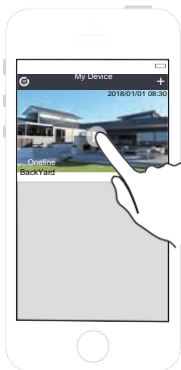
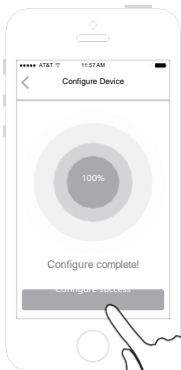

4. Watch Video

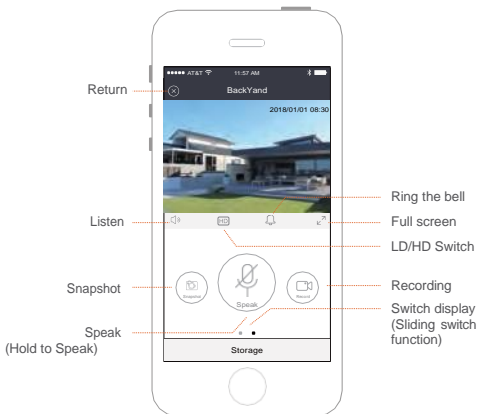
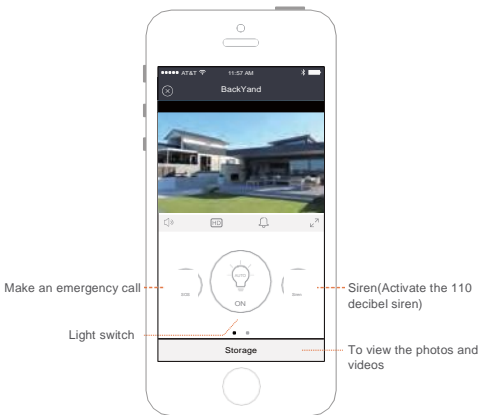

Tips on WIFI Configuration

1. Make sure the device is powered on.
2. Make sure the device is ready to be configured.



Slow blink

-
3. Make sure the phone is connected to WiFi, and the volume is adjusted to maximum.



4. Make sure using the 2.4GHz, and the router's DHCP is turned on. (If you don't know how to switch from 5GHz to 2.4GHz, please consult to the service provider of your Wifi router.)

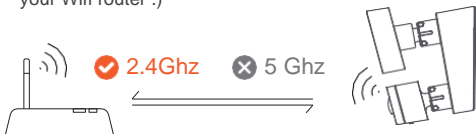

5. Make sure the device, mobile phone, and router are within 5 meters (16 feet) when configuring. Please refer to below diagram.



 Make sure that the router's WiFi password is correct and there are no special characters. Such as %\$#@* ect (WiFi password cannot be blank).

Tips on WIFI Configuration

If it failed again, please:

1. After the device is powered on, press and hold the "Reset" button for 5 seconds , reset the device, wait for 40 seconds, You can move on to next step after the first chime or tone. you will hear the sound 3 times.

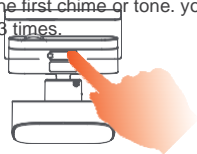

-
2. Reboot the router .



If you USE "Wi-Fi extender" to configure the device, the App will tell you connection failed, but actually it may have succeeded already, you need to follow below diagram for refernce.

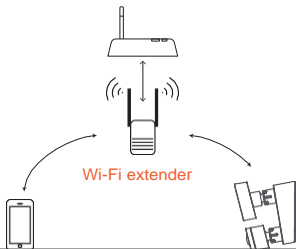

-
1. Open App, Click "+" ,then click "Manual Input ID" .
 2. Input the device UID ,you can find the QR code on backside of the camera,Then input the password and "Save".(Default password is "admin")
 3. If you still can not connect device to Wi-Fi , please contact your vendor .

FAQ

For more questions, please refer to FAQ list in Our APP



1 Open the App, then click "○"



2 Click "FAQ" enter FAQ page



FCC Statement

Changes or modifications not expressly approved by the party responsible for compliance could void the user's authority to operate the equipment.

This equipment has been tested and found to comply with the limits for a Class B digital device, pursuant to Part 15 of the FCC Rules.

These limits are designed to provide reasonable protection against harmful interference in a residential installation.

This equipment generates uses and can radiate radio frequency energy and, if not installed and used in accordance with the instructions, may cause harmful interference to radio communications.

However, there is no guarantee that interference will not occur in a particular installation.

If this equipment does cause harmful interference to radio or television reception, which can be determined by turning the equipment off and on, the user is encouraged to try to correct the interference by one or more of the following measures:

- Reorient or relocate the receiving antenna.
- Increase the separation between the equipment and receiver.
- Connect the equipment into an outlet on a circuit different from that to which the receiver is connected.
- Consult the dealer or an experienced radio/TV technician for help.

This device complies with part 15 of the FCC rules. Operation is subject to the following two conditions (1) this device may not cause harmful interference, and (2) this device must accept any interference received, including interference that may cause undesired operation.

About the User Manual:

The user manual is used as a guide.

The photos, graphic, charts and illustrations provided in the user Manual are only used as explanation and interpretation, which may be different for specific products, please refer to the real object.

The user manual maybe updated because of the products version upgrade or other requirements, if you need the latest version of the user manual, please contact customer service for the latest version of the user manual.

XODO[®]

CONTACT INFORMATION

E-Mail: support@contixo.com

Website: www.contixo.com

©2019 Contixo Inc. All rights reserved. XODO[®], the Contixo logo and associated characters, trademarks and design elements are owned and licensed by Contixo Company.